



# NOVUS 242 SOLAR, LLC

Mountain View Drive  
Jay, Vermont



ISSUED FOR PERMIT REVIEW  
NOT FOR CONSTRUCTION

### SOURCE DATA LEGEND

MAPPING SOURCE DATA USED FOR PLAN COMPILATION

Civil Engineering:  
Krebs and Lansing Consulting Engineers, Inc.  
164 Main Street, Suite 201  
Colchester, Vermont 05446

Environmental:  
Arrowwood Environmental  
950 Bart White Road  
Huntington, Vermont 05462

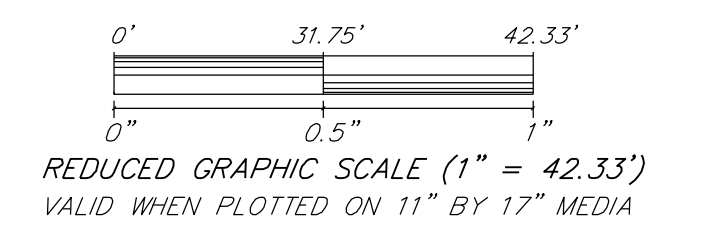
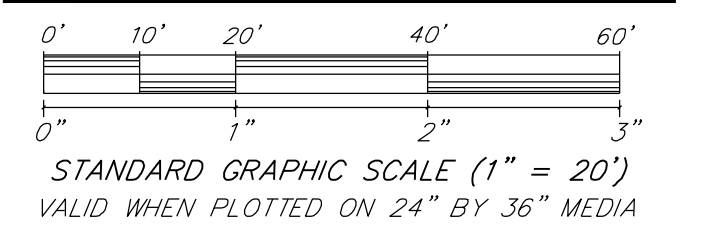

## Proposed Solar Array

REV. NO.	REVISIONS/COMMENTS	DATE

Drawing Title:

### ELEVATION A-A VIEWS

DATE of Issue: 02/03/26  
Drawn by: SDG Checked by: GTD  
Project No.: 17152 Scale: 1" = 20'  
Drawing No.: Rev No.:

**C-101**

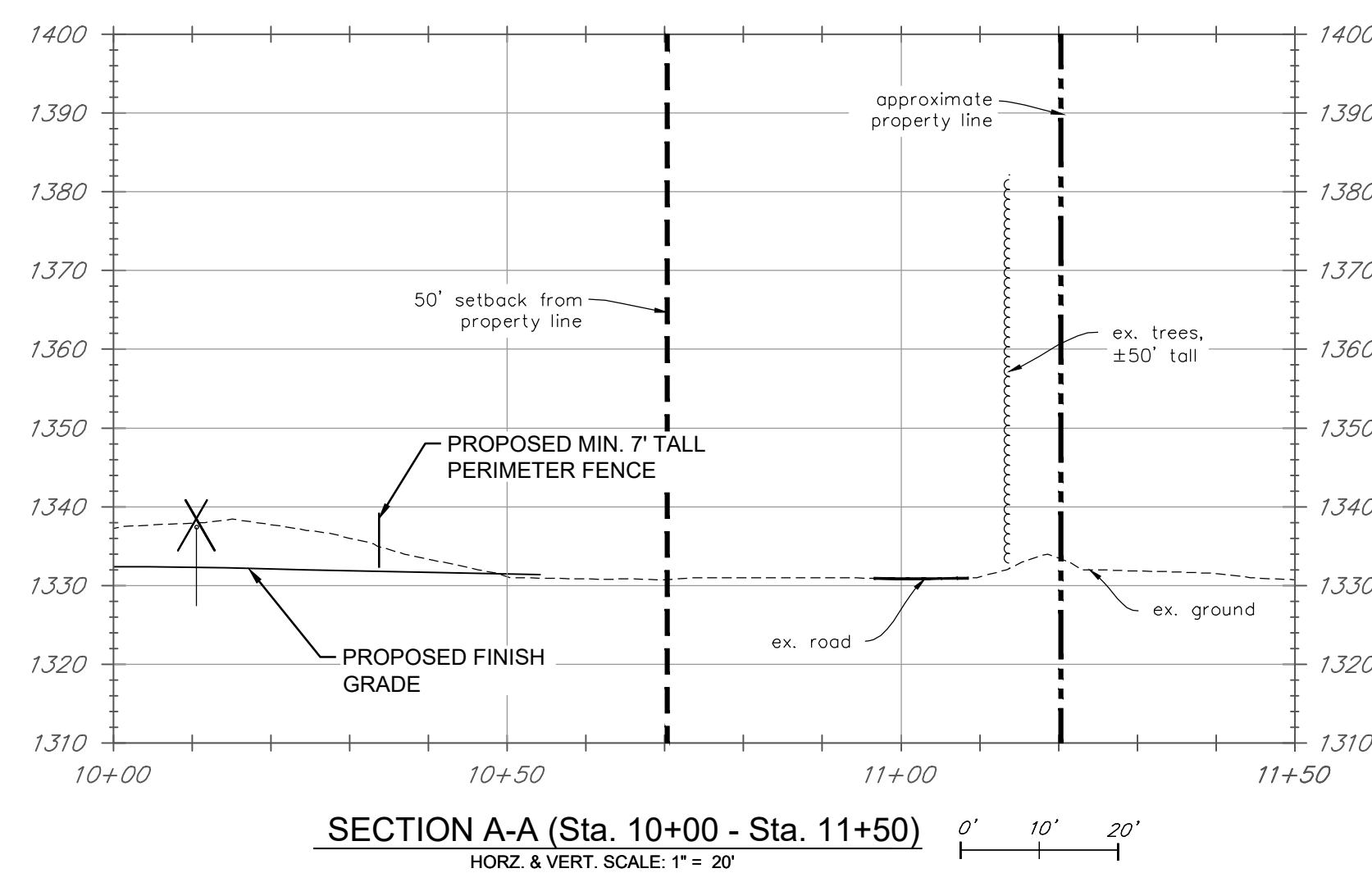
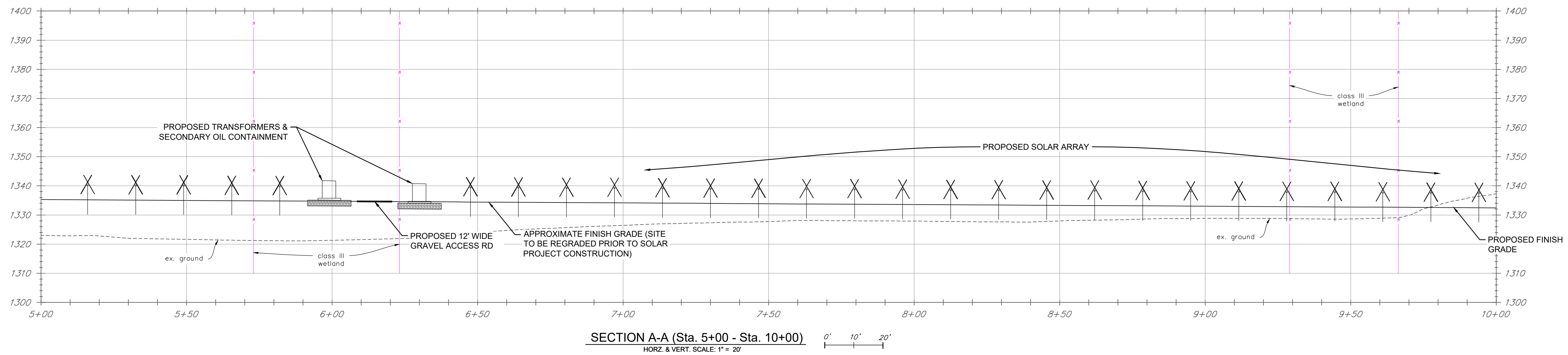
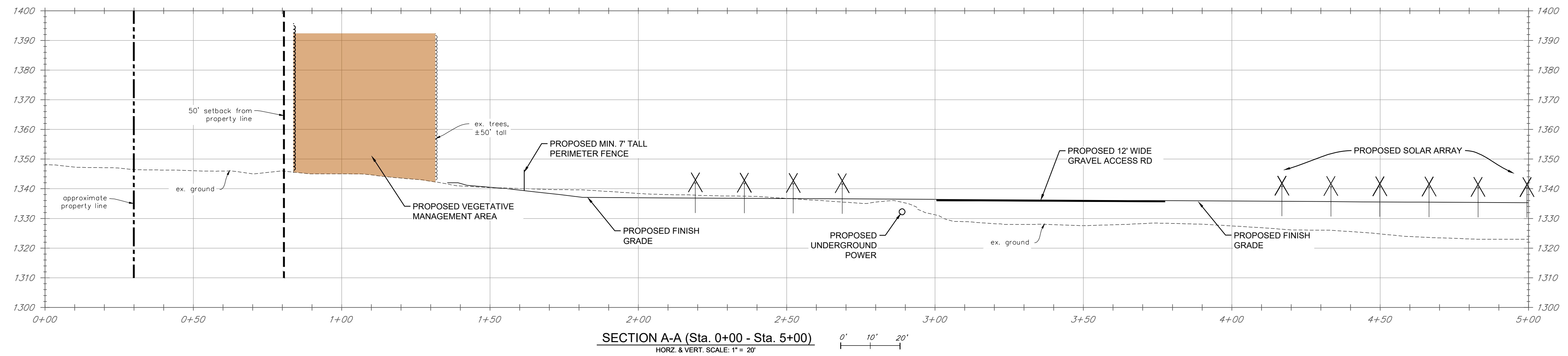

# NOVUS 242 SOLAR, LLC

Mountain View Drive  
Jay, Vermont



ISSUED FOR PERMIT REVIEW  
NOT FOR CONSTRUCTION

**SOURCE DATA LEGEND**

MAPPING SOURCE DATA USED FOR PLAN COMPILATION

Civil Engineering:  
Krebs and Lansing Consulting Engineers, Inc.  
164 Main Street, Suite 201  
Colchester, Vermont 05446

Environmental:  
Arrowwood Environmental  
950 Bart White Road  
Huntington, Vermont 05462

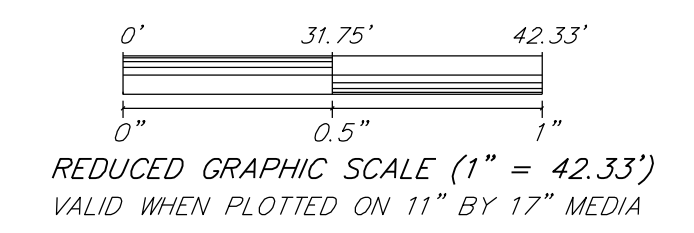
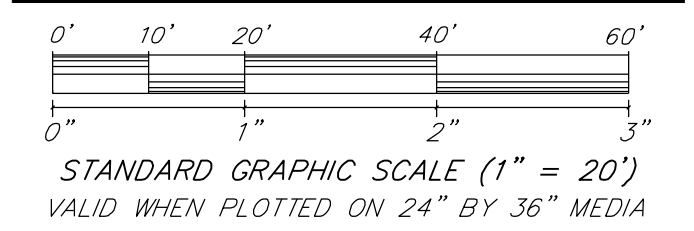

## Proposed Solar Array

REV. NO.	REVISIONS/COMMENTS	DATE

Drawing Title:

**ELEVATION B-B VIEWS**

DATE of Issue: 02/03/26  
 Drawn by: SDG Checked by: GTD  
 Project No.: 17152 Scale: 1" = 20'  
 Drawing No.: Rev No.:

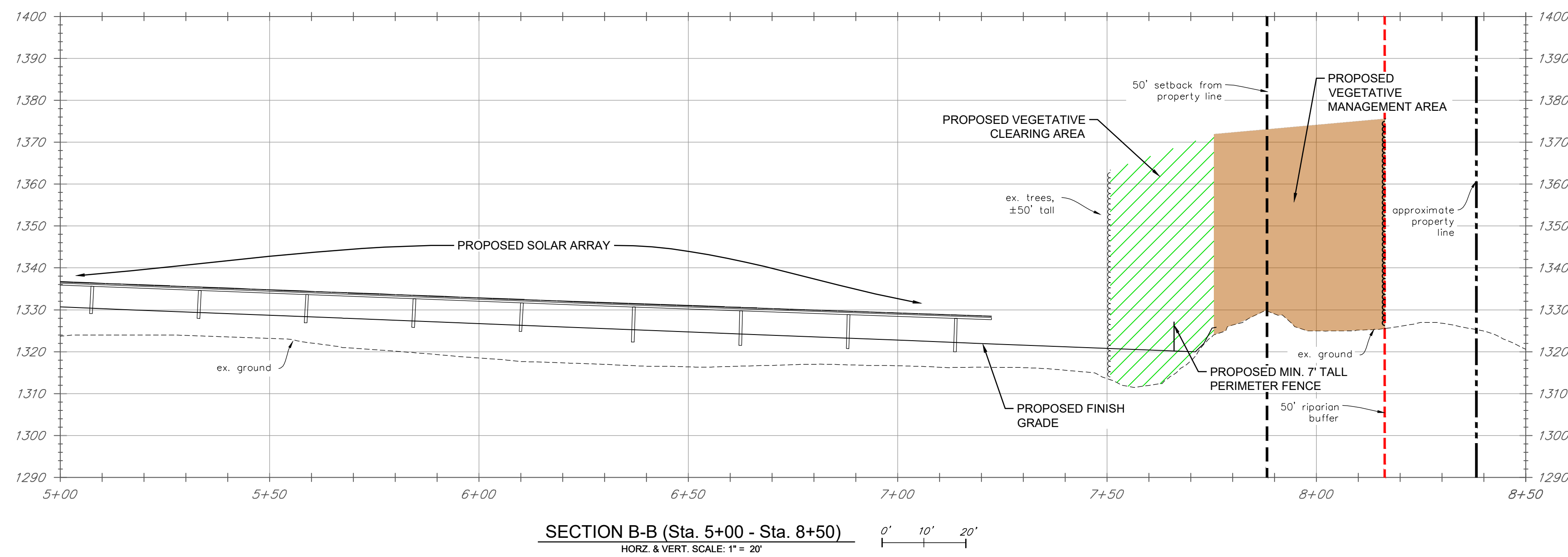
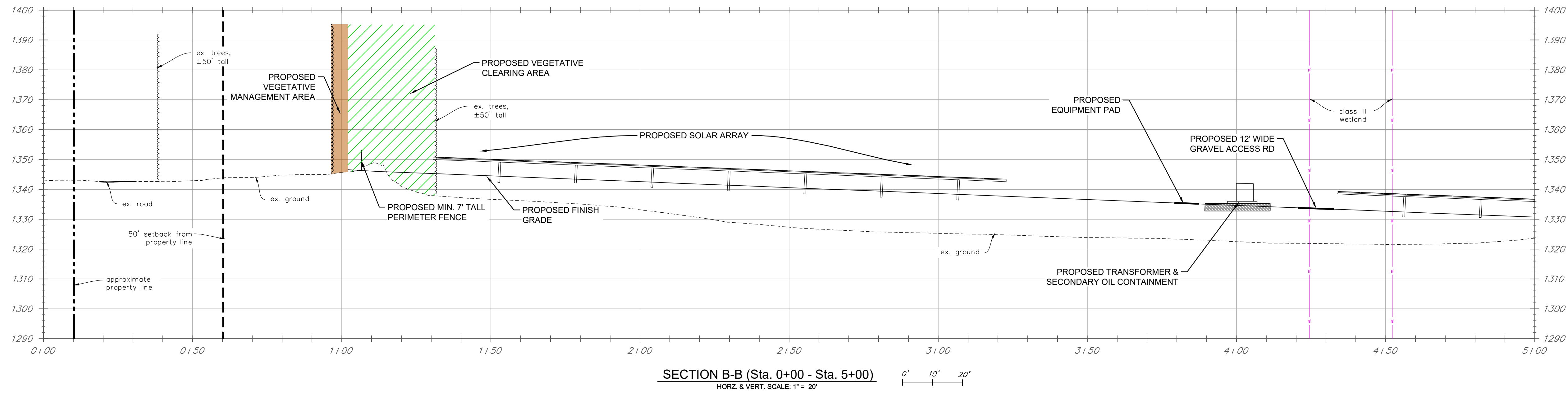



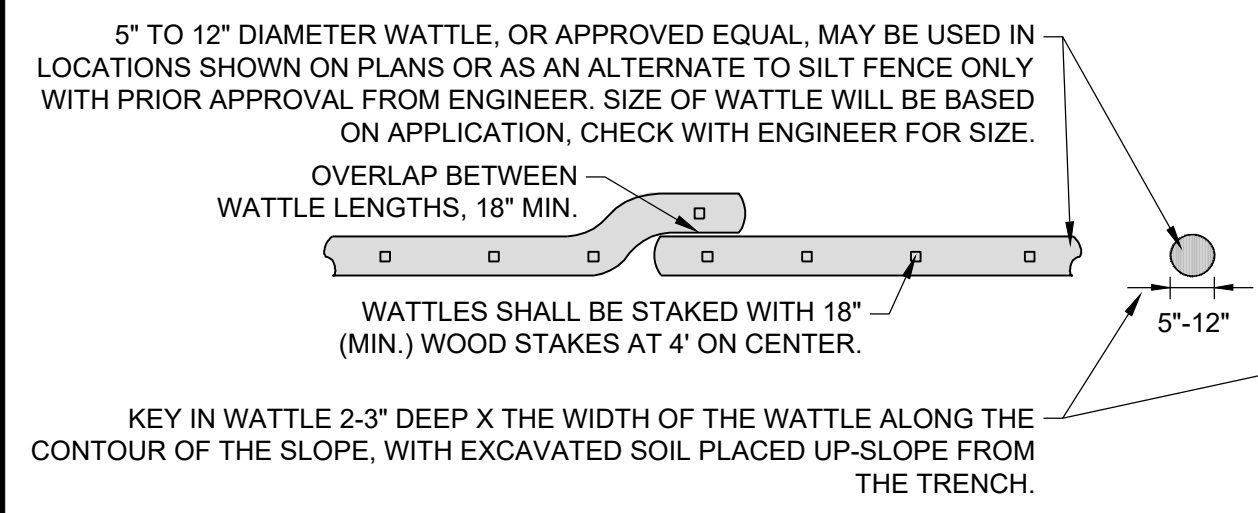

- NOTES**
- CONTRACTOR SHALL BE RESPONSIBLE FOR THE INSTALLATION, MAINTENANCE, AND REMOVAL OF WATTLE IN ALL LOCATIONS SHOWN ON THE PLANS. WATTLE MAY BE LEFT IN PLACE IF THE CONTRACTOR SEEDS AND MULCHES OVER WATTLE FOR GROWTH POST CONSTRUCTION.
  - MAINTENANCE SHALL BE PERFORMED AS NEEDED AND ADDITIONAL WATTLES WILL BE ADDED WHEN SEDIMENT REACHES HALF OF PRODUCT HEIGHT.
  - WHEN INSTALLING LENGTHS OF WATTLE, LENGTHS WILL OVERLAP BY MINIMUM 18" WHEN TRANSITIONING TO A NEW LENGTH OF WATTLE.
  - CONTRACTOR SHALL REFER TO ALL MANUFACTURERS SPECIFICATIONS AND DETAILS.
  - SILTSOXX IS A SPECIFIC MANUFACTURER, OTHER MANUFACTURERS WITH EQUAL PRODUCTS MAY BE USED IF APPROVED BY ENGINEER.
  - WATTLE CAN BE USED AS A SILT FENCE ALTERNATIVE, WITH PRIOR APPROVAL OF THE ENGINEER.

**TYPICAL WATTLE SEDIMENT CONTROL**  
N.T.S.

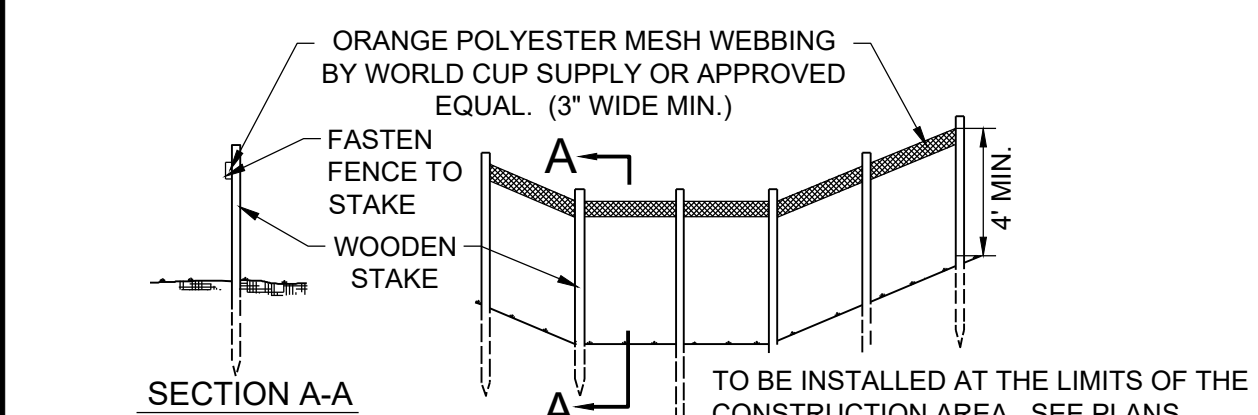

- NOTES**
- ACCEPTABLE EPSC MEASURE DETAILS ARE PROVIDED BELOW.
  - AT A MINIMUM, EPSC MEASURES MEET VT DEC STANDARDS AND SPECIFICATIONS FOR EROSION PREVENTION AND SEDIMENT CONTROL OR PREVIOUSLY APPROVED INTERCHANGEABLE PRACTICES.
  - LIMITS OF DISTURBANCE (OR "CONSTRUCTION DEMARCATION") SHALL BE INSTALLED PRIOR TO ANY EARTH DISTURBING ACTIVITIES.
  - BARRIER TAPE/ROPE: FOR USE WHERE PROPOSED DISTURBANCE BORDERS NON-WOODED, VEGETATED AREAS MORE THAN 100 FT FROM THE NEAREST WATER RESOURCE (STREAM, BROOK, LAKE, POND, WETLAND, ETC.). BARRIER TAPE IS HIGH VISIBILITY FIBERGLASS TAPE, MINIMUM 3" IN WIDTH COMMONLY USED IN SKI AREAS FOR DEMARCATING CLOSED AREAS. BARRIER TAPE AND ROPE SHOULD BE ATTACHED TO STAKES, AT A MINIMUM HEIGHT OF 4 FT FROM THE GROUND.
  - MINIMUM 1 TO 2 ROWS OF MESH BARRIER TAPE TO BE INSTALLED ALONG CONSTRUCTION PERIMETER.
  - EACH ROW OF BARRIER TAPE TO BE 3" WIDE MINIMUM.
  - BARRIER TAPE TO BE ORANGE.
  - SECURE BARRIER TAPE TO STAKES OR EXISTING TREE TRUNKS WITH BOTTOM ROW AT 4' DISTANCE FROM GROUND SURFACE (MINIMUM).
  - MAINTAIN AND REPLACE AS NEEDED. REMOVE AT COMPLETION OF PROJECT PER OSPC.
  - IN EVENT THE OSPC DETERMINES BARRIER TAPE IS NOT SUFFICIENT, REPLACE WITH ORANGE CONSTRUCTION FENCE OR SNOW FENCE.

**TYPICAL CONSTRUCTION LIMIT BARRIER**  
N.T.S.

**CONSTRUCTION STORMWATER DISCHARGE PERMIT INFORMATION**

- THIS PROJECT PROPOSES 17.39 ACRES OF SOIL DISTURBANCE ON SITE.
- THE PROPOSED PROJECT HAS BEEN SCORED USING THE STATE OF VERMONT APPENDIX-A RISK EVALUATION. THE PROJECT WILL APPLY FOR A MODERATE RISK OR INDIVIDUAL CONSTRUCTION STORMWATER DISCHARGE PERMIT.
- THE MAXIMUM AREA OF EARTH DISTURBANCE AT ANY ONE TIME SHALL NOT EXCEED 10 ACRES.
- ALL AREAS OF EARTH DISTURBANCE MUST HAVE TEMPORARY OR FINAL STABILIZATION WITHIN 14 DAYS OF THE INITIAL DISTURBANCE. AFTER THIS TIME, DISTURBED AREAS MUST BE TEMPORARILY OR PERMANENTLY STABILIZED IN ADVANCE OF ANY RUNOFF PRODUCTION EVENT, WITH THE FOLLOWING EXCEPTION:  
ii. STABILIZATION IS NOT REQUIRED IF THE WORK IS OCCURRING IN A SELF-CONTAINED EXCAVATION (I.E., NO OUTLET FOR STORMWATER) WITH A DEPTH OF 2 FEET OR GREATER (E.G., UNDERGROUND LINE INSTALLATION).
- PROJECT DOES PROPOSE WINTER CONSTRUCTION. WINTER CONSTRUCTION NOTES ARE INCLUDED.
- ALL TEMPORARY EPSC MEASURES SHALL BE REMOVED WITHIN 30 DAYS AFTER FINAL SITE STABILIZATION OR AFTER THE TEMPORARY EPSC MEASURES ARE NO LONGER NEEDED, UNLESS OTHERWISE AUTHORIZED AND APPROVED IN WRITING BY THE OWNER.
- SOIL STABILIZATION SHALL BE ACHIEVED BY SEED AND MULCH, HYDROSEEDING WITH MULCH TACKIFIER, SOD, STONE, AND/OR ROLLED EROSION CONTROL PRODUCTS (E.G., EROSION CONTROL BLANKET). MULCH SHALL BE COMPRISED OF STRAW, HAY, COMPOST, WOODCHIPS, WOOD STUMP GRINDINGS, AND/OR EROSION CONTROL MIX.
- APPROPRIATE SEED MIX SHALL BE APPLIED TO DESIGNATED AREAS PER THIS EPSC PLAN AND SEED SPECIFICATIONS.

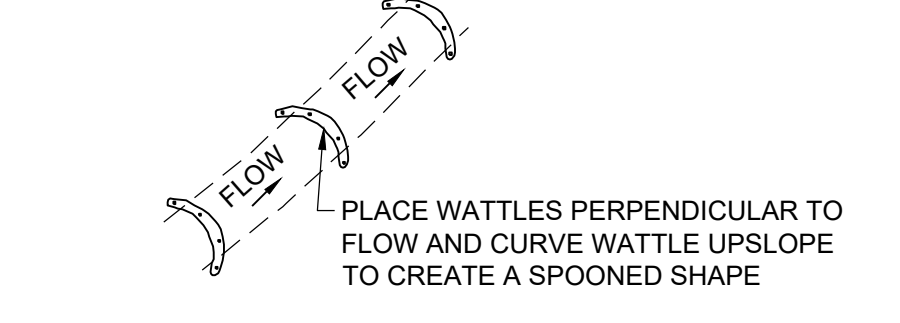
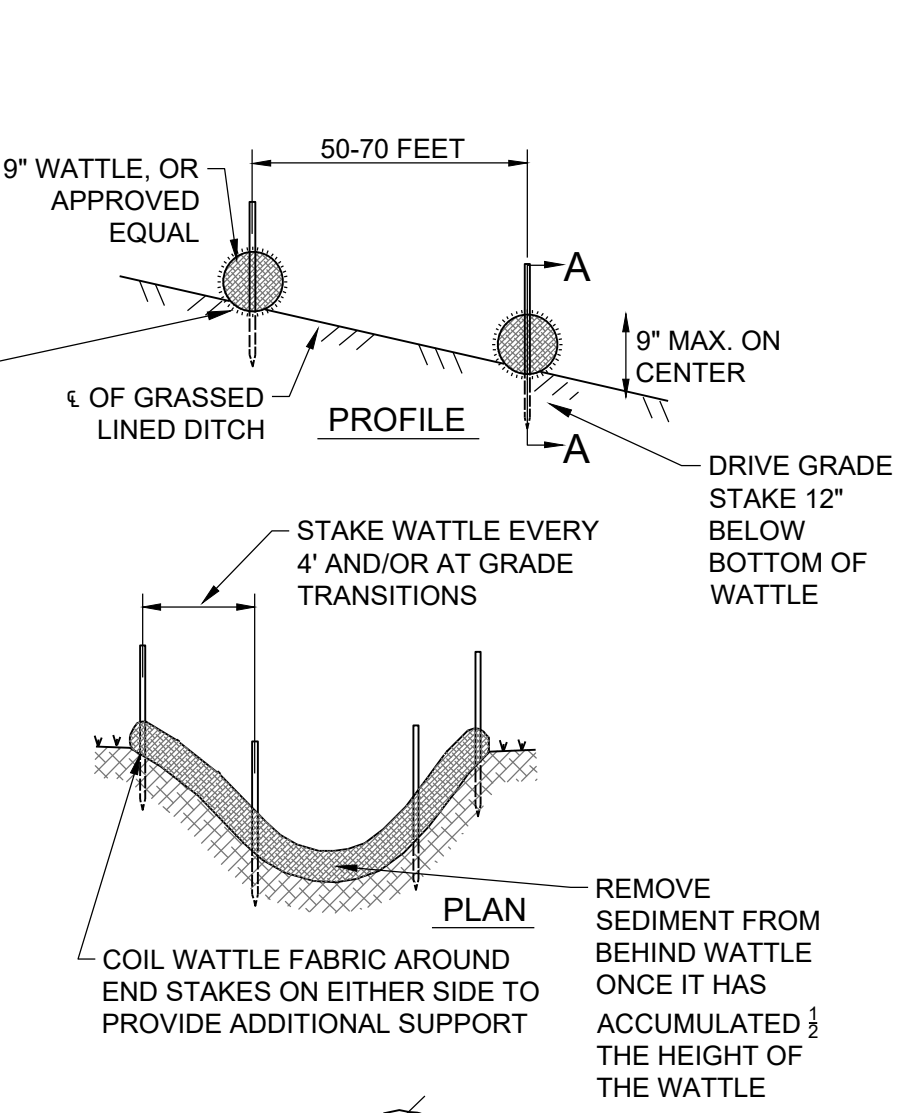

- NOTES**
- CONTRACTOR SHALL BE RESPONSIBLE FOR THE INSTALLATION, MAINTENANCE, AND REMOVAL OF WATTLE IN ALL LOCATIONS SHOWN ON THE PLANS. WATTLE MAY BE LEFT IN PLACE IF THE CONTRACTOR SEEDS AND MULCHES WATTLE FOR GROWTH POST CONSTRUCTION.
  - MAINTENANCE SHALL BE PERFORMED AS NEEDED AND ADDITIONAL WATTLE WILL BE ADDED WHEN SEDIMENT REACHES HALF OF PRODUCT HEIGHT.
  - WHEN INSTALLING LENGTHS OF WATTLE, LENGTHS WILL OVERLAP BY MINIMUM 18" WHEN TRANSITIONING TO A NEW LENGTH OF WATTLE.
  - CONTRACTOR SHALL REFER TO ALL MANUFACTURERS SPECIFICATIONS AND DETAILS.
  - WATTLE CAN ONLY BE USED IN A GRASS LINED SWALE, MAY NOT BE USED IN STONE LINED SWALES.
  - WATTLE CHECK DAM CAN ONLY BE USED IN CHANNELS WITH SLOPES LESS THAN 5%.
  - SILTSOXX IS A SPECIFIC MANUFACTURER, OTHER MANUFACTURERS WITH EQUAL PRODUCTS MAY BE USED IF APPROVED BY ENGINEER.

**SILT FENCE SPACING CHART**

SLOPE	SPACING
5% TO 10%	50 FT. OR LESS
10% TO 20%	25 FT. OR LESS
> 20%	15 FT. OR LESS

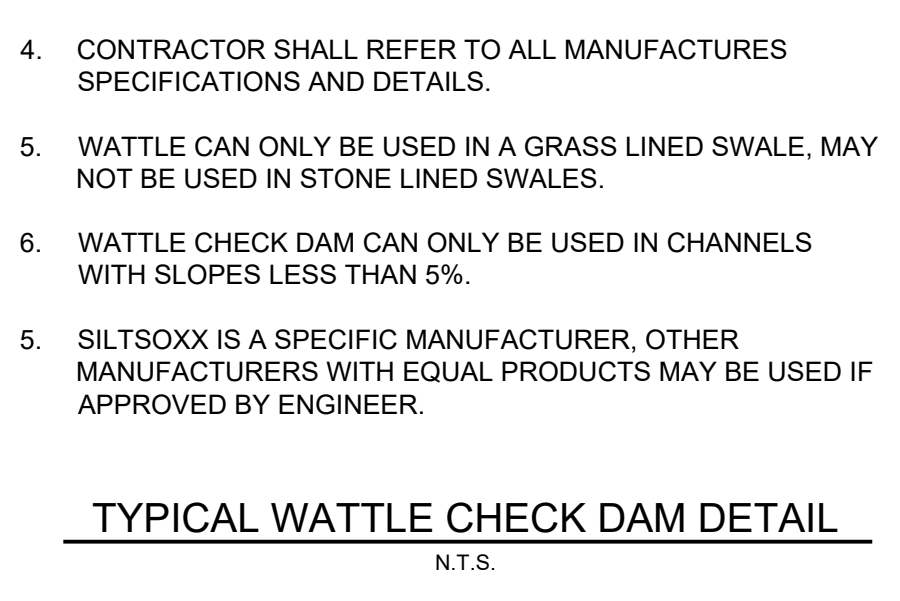

**TYPICAL STABILIZED STAGING AREA SURFACE**  
N.T.S.

- NOTES**
- CONTRACTOR SHALL STABILIZE CONSTRUCTION ENTRANCE AS REQUIRED TO PREVENT TRACKING OF SEDIMENT OFF-SITE.
  - CONTRACTOR TO USE MIRAFI 500X UNDER STONE FOR TEMPORARY CONSTRUCTION ROADS.
  - CRUSHED STONE SHALL BE ADDED OR REPLACED WHEN 80% OF THE VOIDS ARE FILLED WITH SEDIMENT.
  - STONE SIZE SHALL BE 1-4".
  - ALL SURFACE WATER FLOWING OR DIVERTED TOWARD CONSTRUCTION ENTRANCE SHALL BE PIPED BENEATH ENTRANCE. IF PIPING IS IMPRACTICAL, A MOUNTABLE BERM WITH 5:1 SLOPES IS ALLOWED.

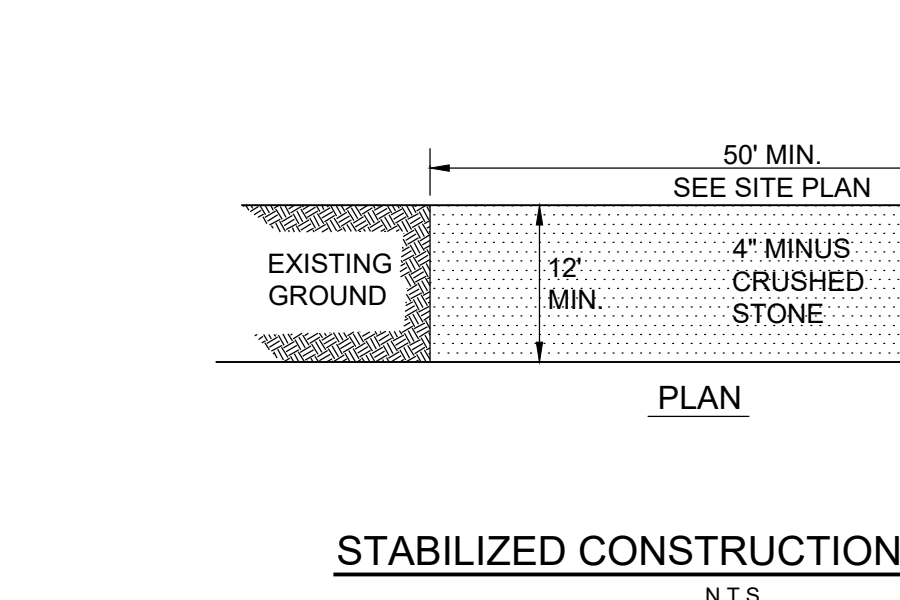
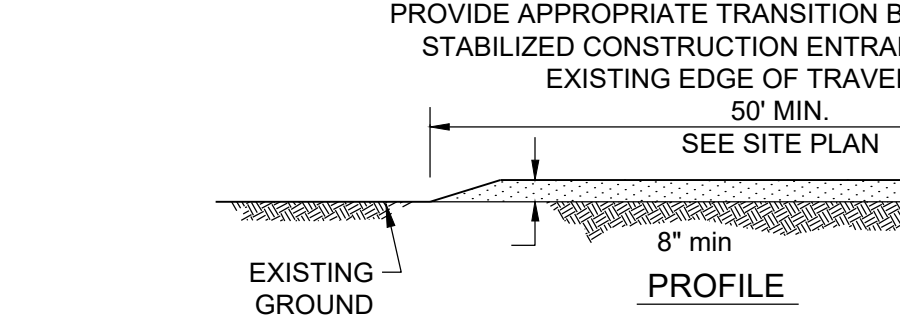
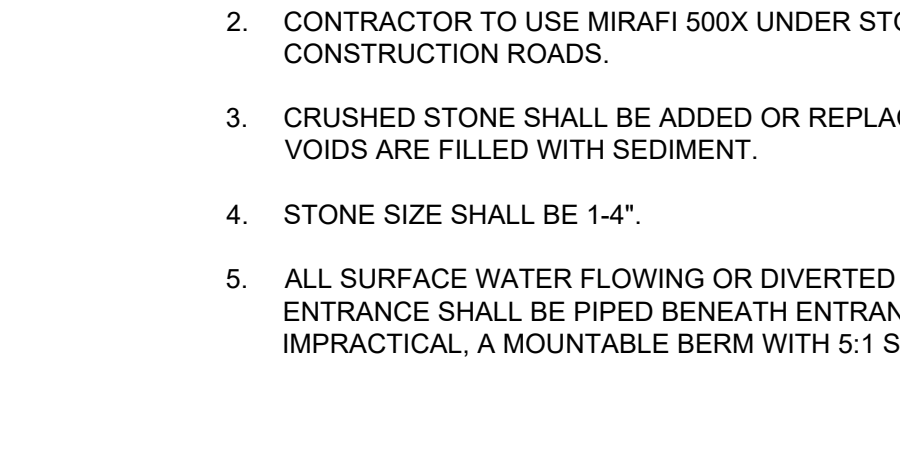

**TYPICAL SILT FENCE "J-HOOK" CONSTRUCTION**  
N.T.S.

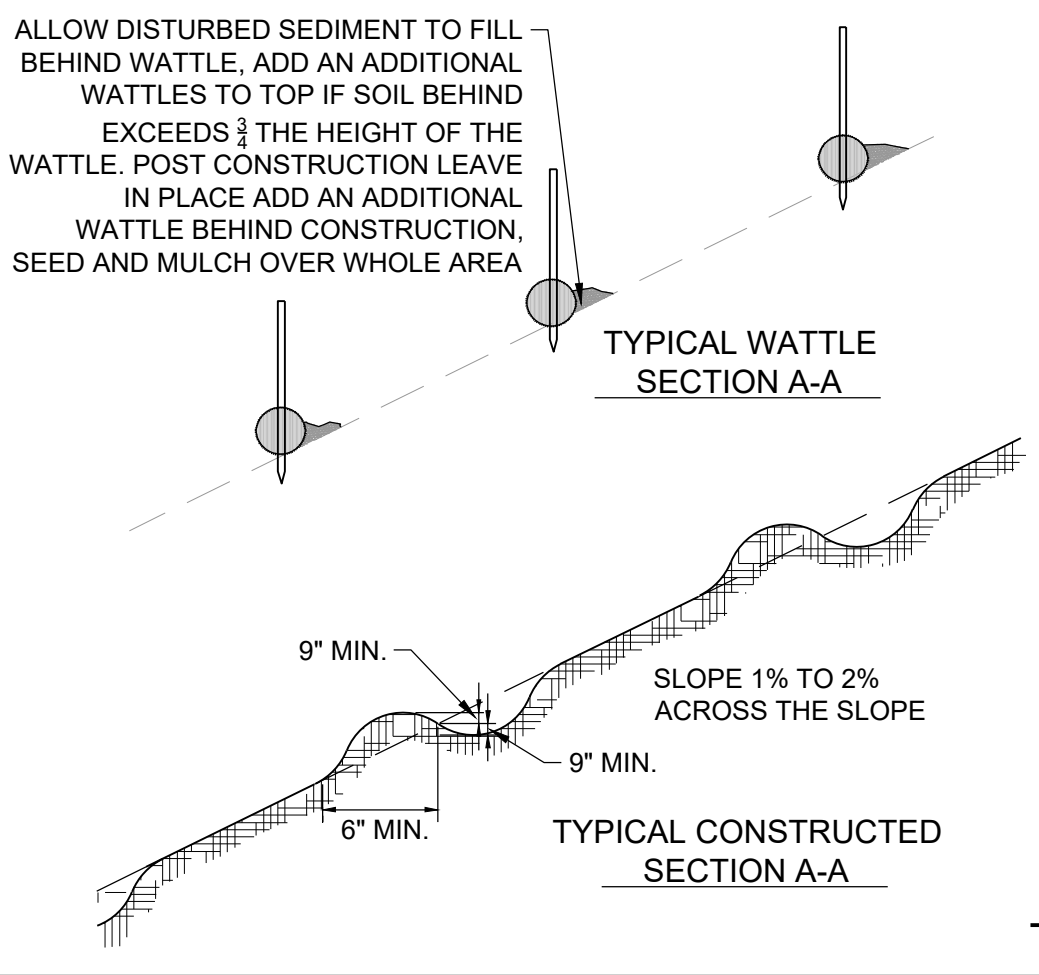

- NOTES**
- AT A MINIMUM, EPSC MEASURES MEET VT DEC STANDARDS AND SPECIFICATIONS FOR EROSION PREVENTION AND SEDIMENT CONTROL OR PREVIOUSLY APPROVED INTERCHANGEABLE PRACTICES.
  - PERIMETER CONTROLS SHALL BE UTILIZED IN SMALL AREAS < 1 ACRE. IN AREAS > 1 ACRE, TEMPORARY SEDIMENT TRAPS OR TEMPORARY SEDIMENT BASINS ARE TO BE UTILIZED.
  - PERIMETER CONTROLS SHALL BE INSTALLED ON DOWNSLOPE SIDE OF PLANNED EARTH DISTURBANCE.
  - PERIMETER CONTROLS SHALL BE INSTALLED PRIOR TO ANY EARTH DISTURBING ACTIVITIES WITHIN UPSLOPE CONTRIBUTING AREA.
  - SILT FENCE SHALL NOT BE USED AS CONSTRUCTION DEMARCATION.
  - SILTSOXX CAN BE USED AS A SILT FENCE ALTERNATIVE, WITH PRIOR APPROVAL OF THE ENGINEER. SEE DETAIL.
  - IF SILT FENCE IS INSTALLED WHEN GROUND IS FROZEN, A GRAVEL, SHOT ROCK, OR SAND BALLAST MUST BE USED.

**TYPICAL WATTLE SECTION A-A**  
N.T.S.

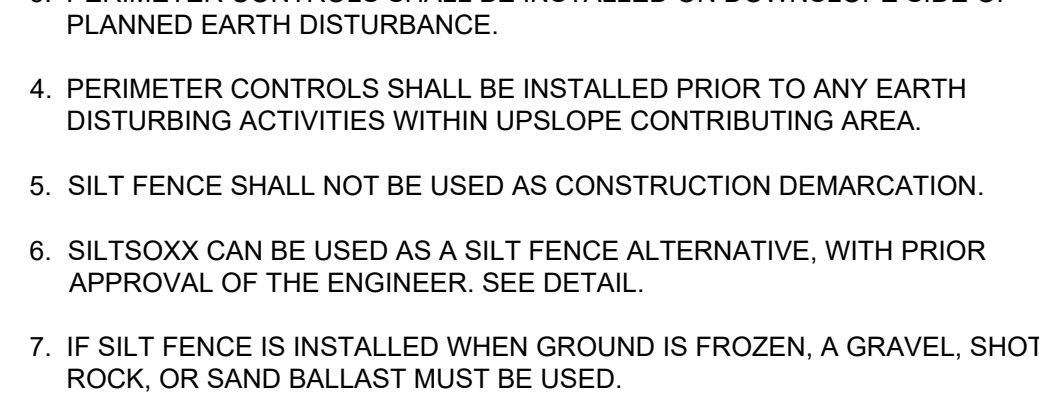

**TYPICAL WATTLE SECTION A-A**  
N.T.S.

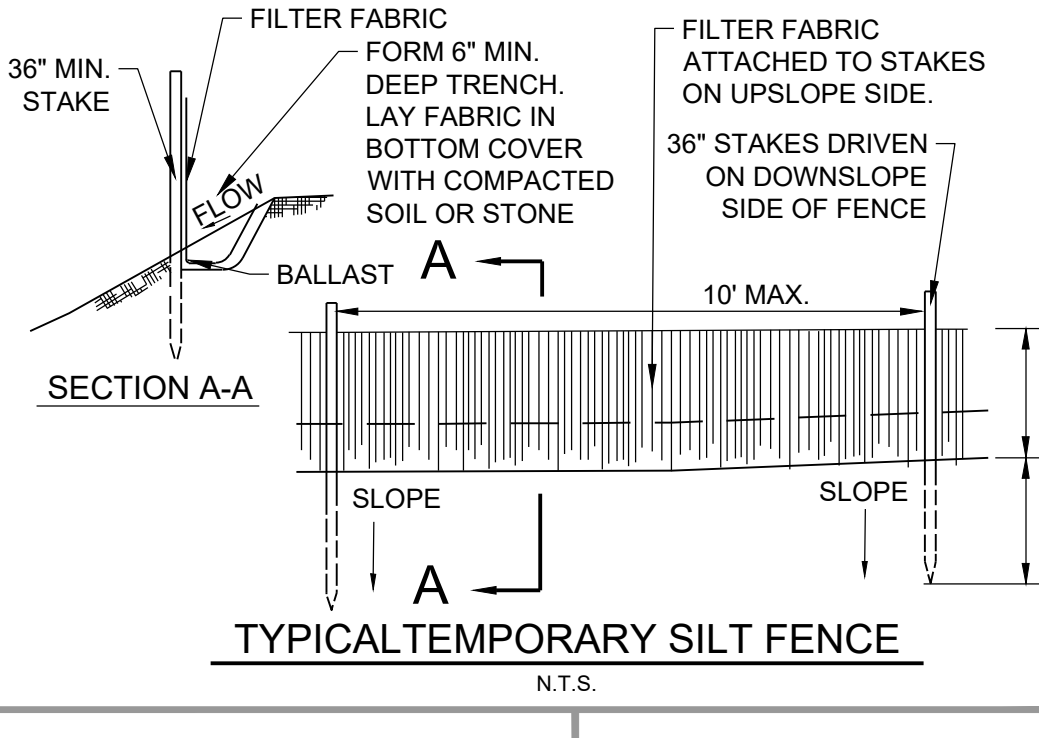

**TYPICAL WATTLE SECTION A-A**  
N.T.S.

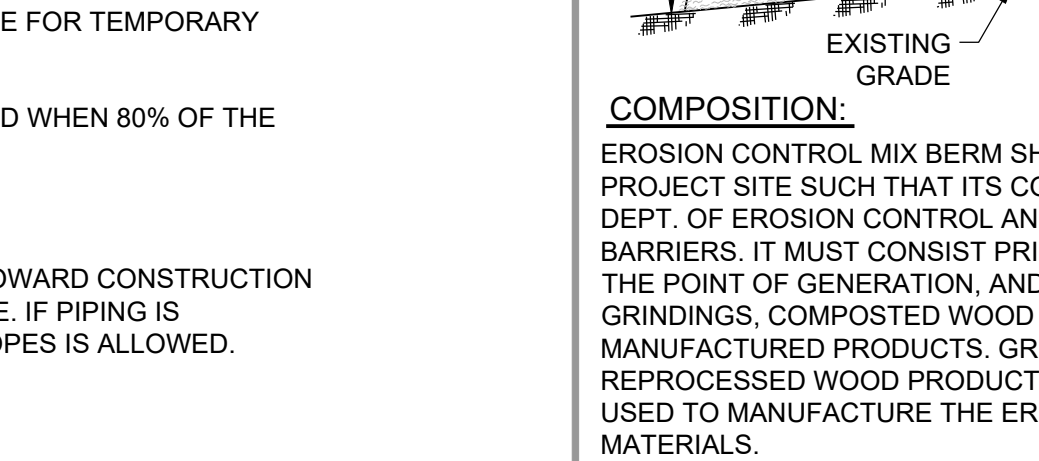

**TYPICAL WATTLE SECTION A-A**  
N.T.S.

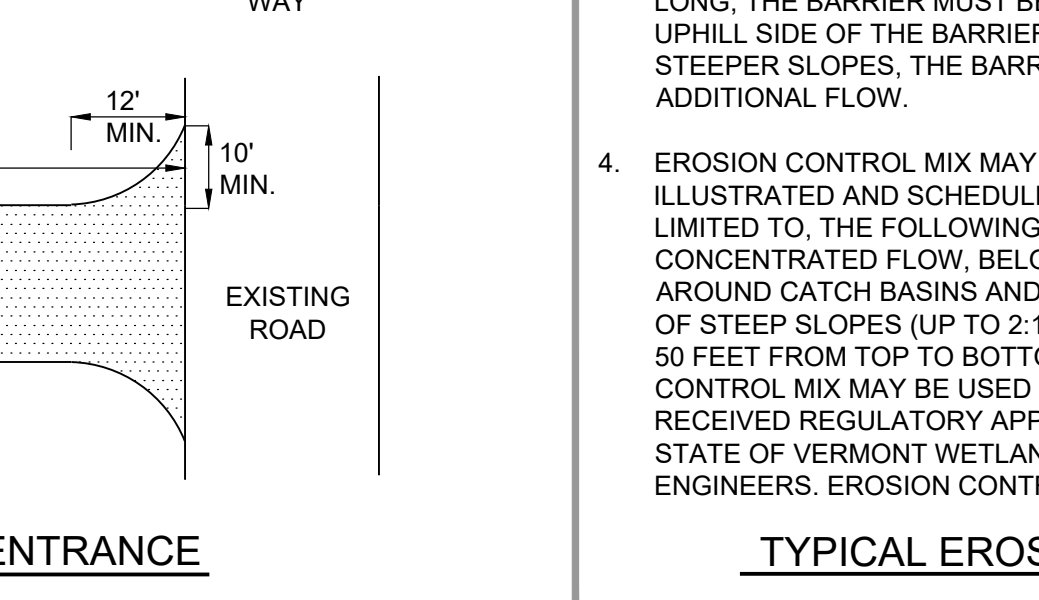

**TYPICAL WATTLE SECTION A-A**  
N.T.S.

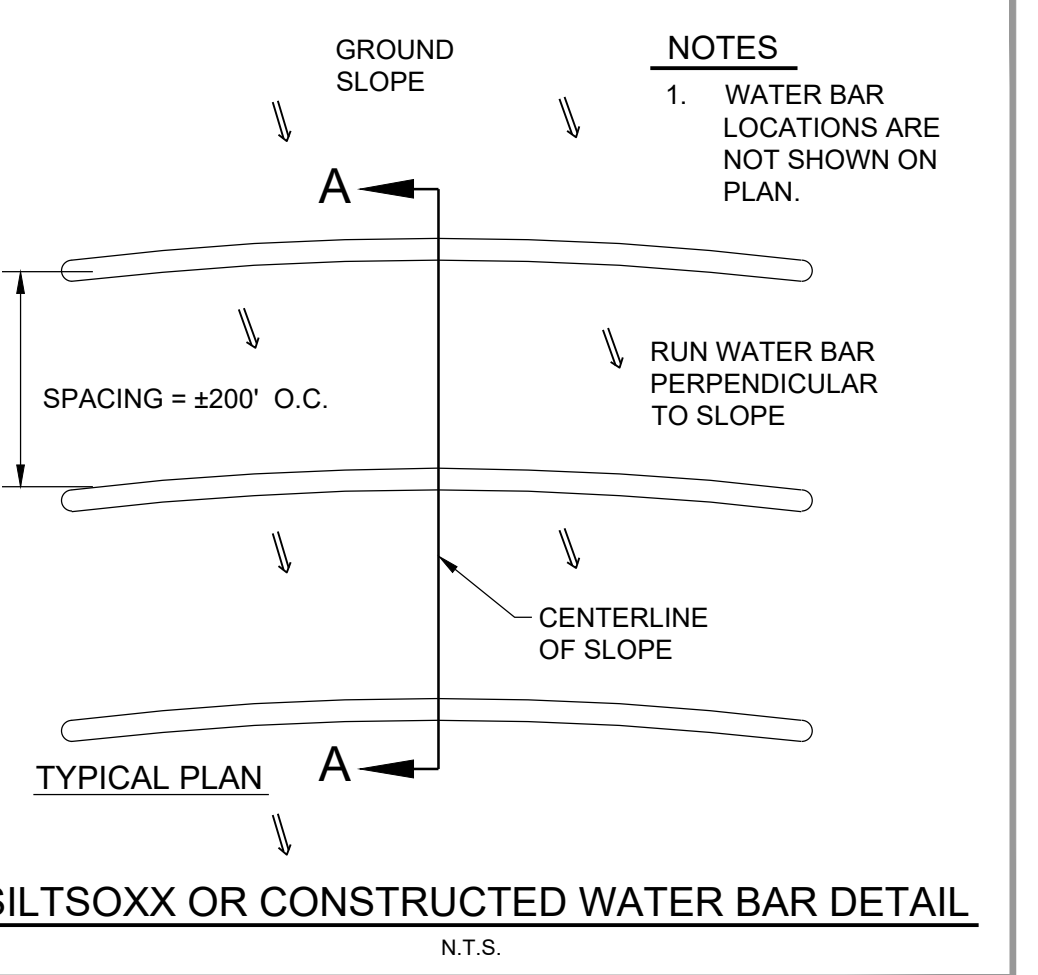

- NOTES**
- CONTRACTOR SHALL BE RESPONSIBLE FOR THE INSTALLATION, MAINTENANCE, AND REMOVAL OF WATTLE IN ALL LOCATIONS SHOWN ON THE PLANS. WATTLE MAY BE LEFT IN PLACE IF THE CONTRACTOR SEEDS AND MULCHES WATTLE FOR GROWTH POST CONSTRUCTION.
  - MAINTENANCE SHALL BE PERFORMED AS NEEDED AND ADDITIONAL WATTLES WILL BE ADDED WHEN SEDIMENT REACHES HALF OF PRODUCT HEIGHT.
  - WHEN INSTALLING LENGTHS OF WATTLE, LENGTHS WILL OVERLAP BY MINIMUM 18" WHEN TRANSITIONING TO A NEW LENGTH OF WATTLE.
  - CONTRACTOR SHALL REFER TO ALL MANUFACTURERS SPECIFICATIONS AND DETAILS.
  - SILTSOXX IS A SPECIFIC MANUFACTURER, OTHER MANUFACTURERS WITH EQUAL PRODUCTS MAY BE USED IF APPROVED BY ENGINEER.
  - WATTLE CAN BE USED AS A SILT FENCE ALTERNATIVE, WITH PRIOR APPROVAL OF THE ENGINEER.

**TYPICAL WATTLE SECTION A-A**  
N.T.S.

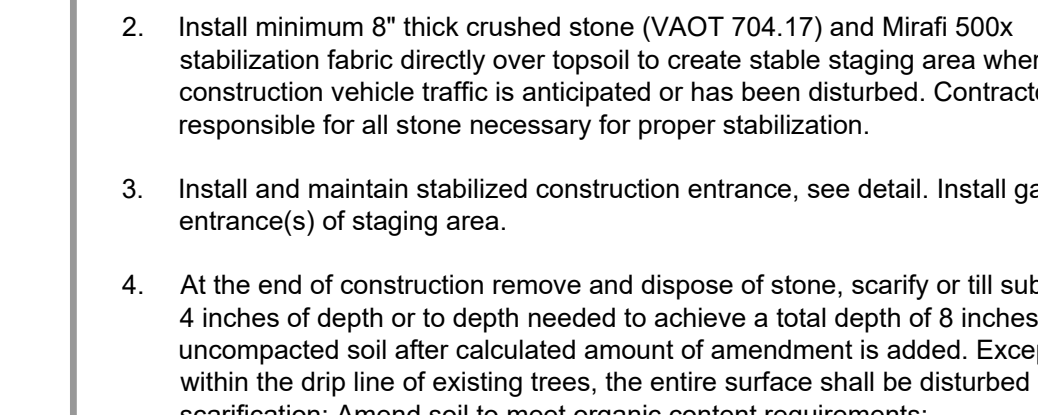

**TYPICAL WATTLE SECTION A-A**  
N.T.S.

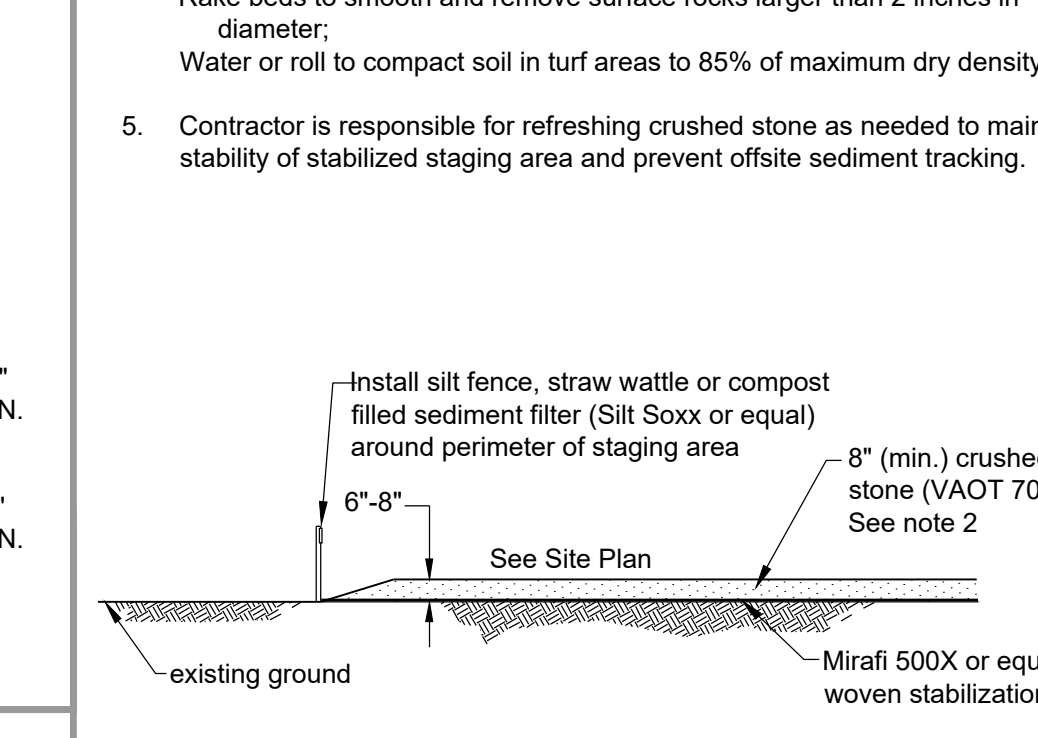

**TYPICAL WATTLE SECTION A-A**  
N.T.S.

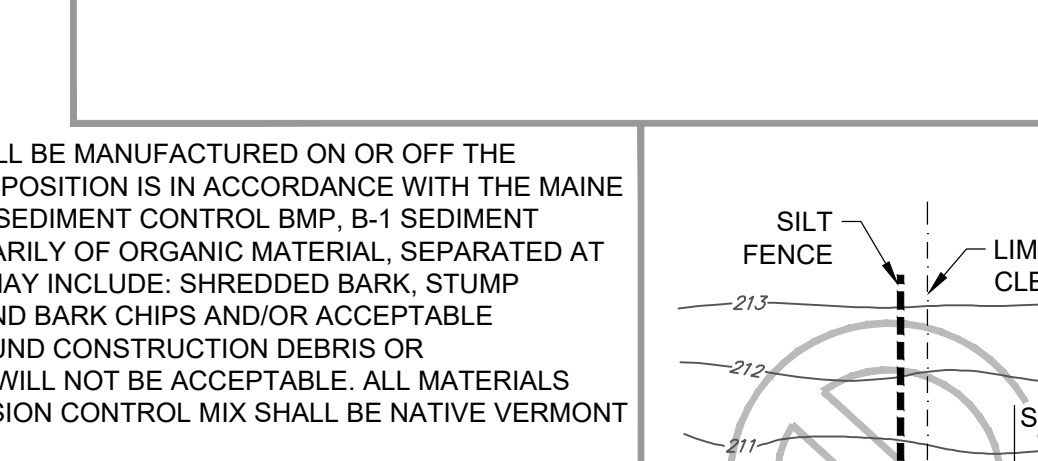

**TYPICAL WATTLE SECTION A-A**  
N.T.S.

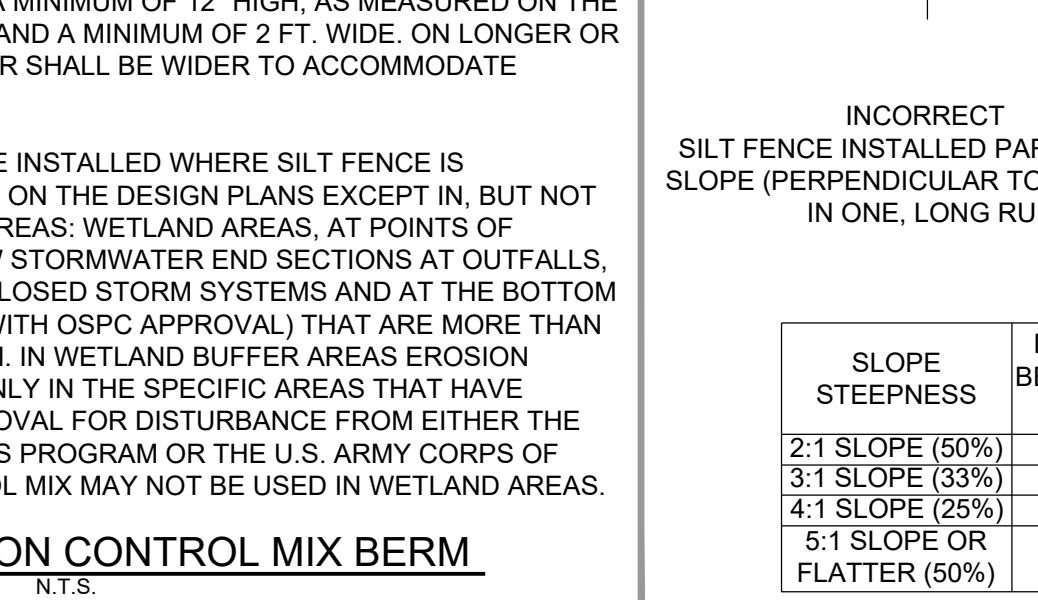

**TYPICAL WATTLE SECTION A-A**  
N.T.S.

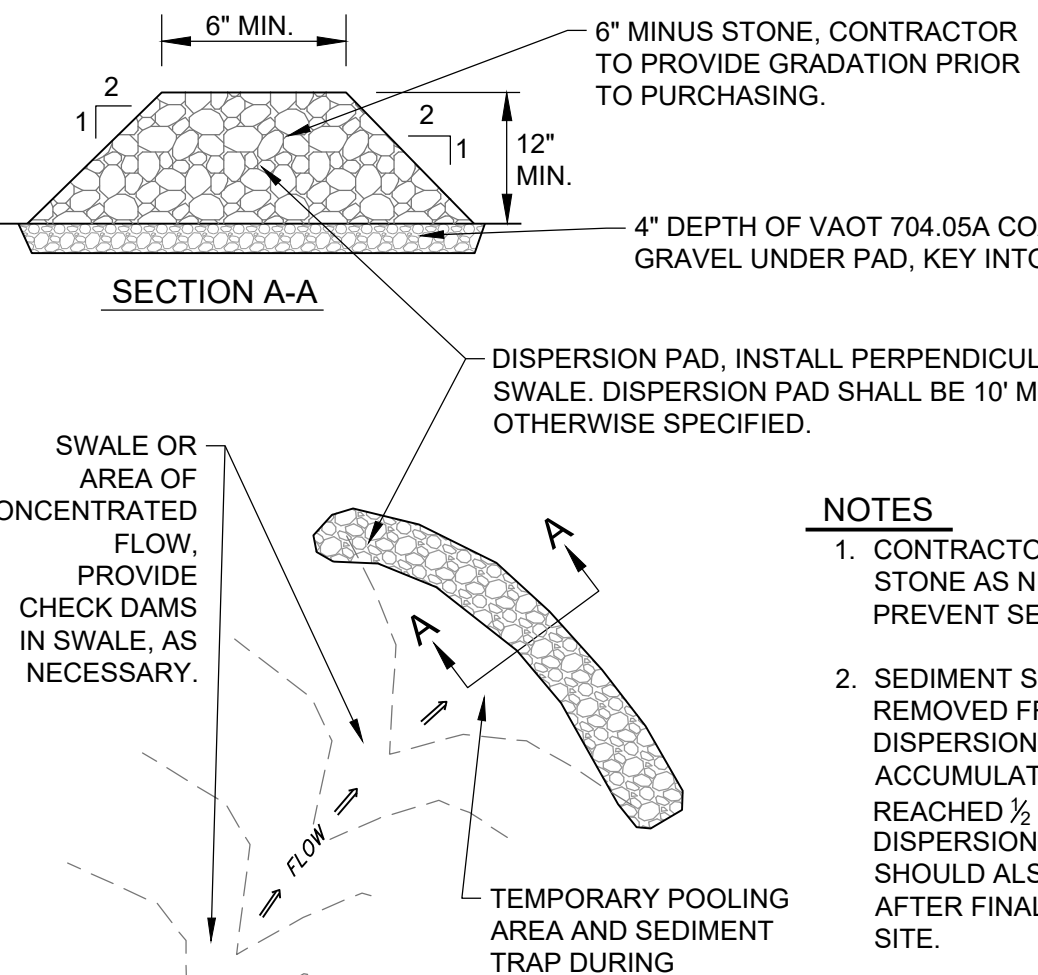

- NOTES**
- CONTRACTOR SHALL REPLACE STONE AS NECESSARY TO PREVENT SEDIMENT BUILD UP.
  - SEDIMENT SHOULD BE REMOVED FROM BEHIND DISPERSION PAD ONCE THE ACCUMULATED HEIGHT HAS REACHED 1/2 THE HEIGHT OF THE DISPERSION PAD. SEDIMENT SHOULD ALSO BE REMOVED AFTER FINAL STABILIZATION OF SITE.

**DISPERSION PAD DETAIL**  
N.T.S.

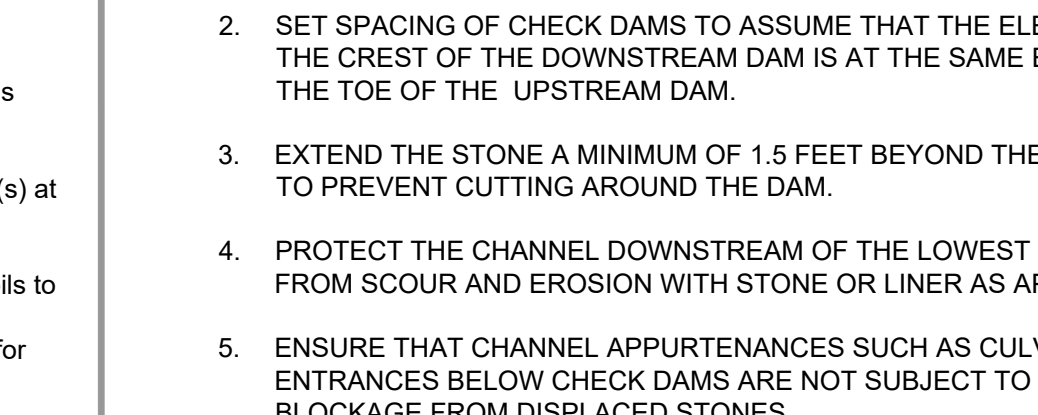

**TYPICAL WATTLE SECTION A-A**  
N.T.S.

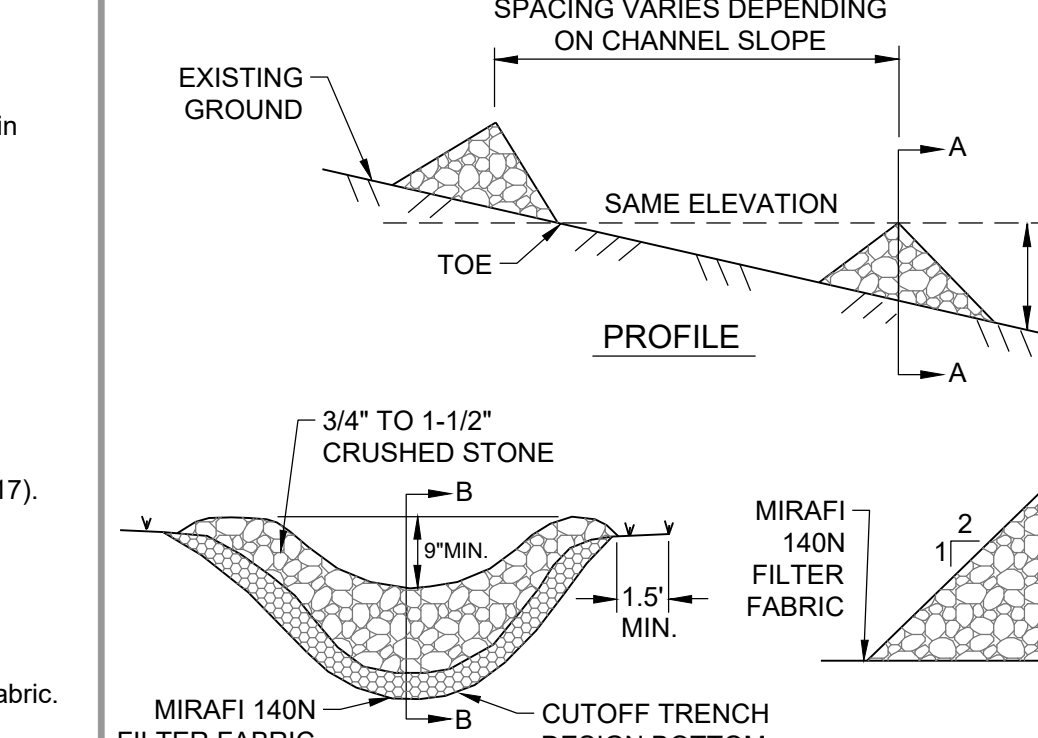

**TYPICAL WATTLE SECTION A-A**  
N.T.S.

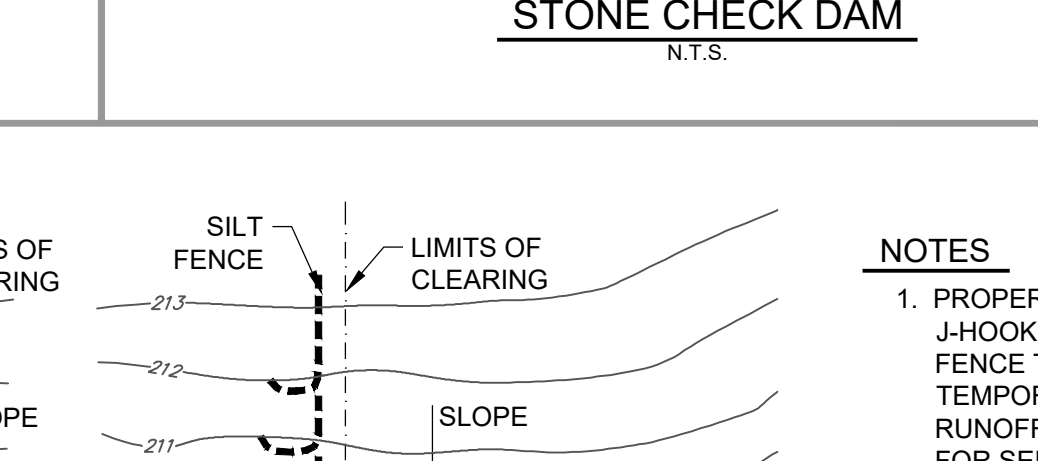

**TYPICAL WATTLE SECTION A-A**  
N.T.S.

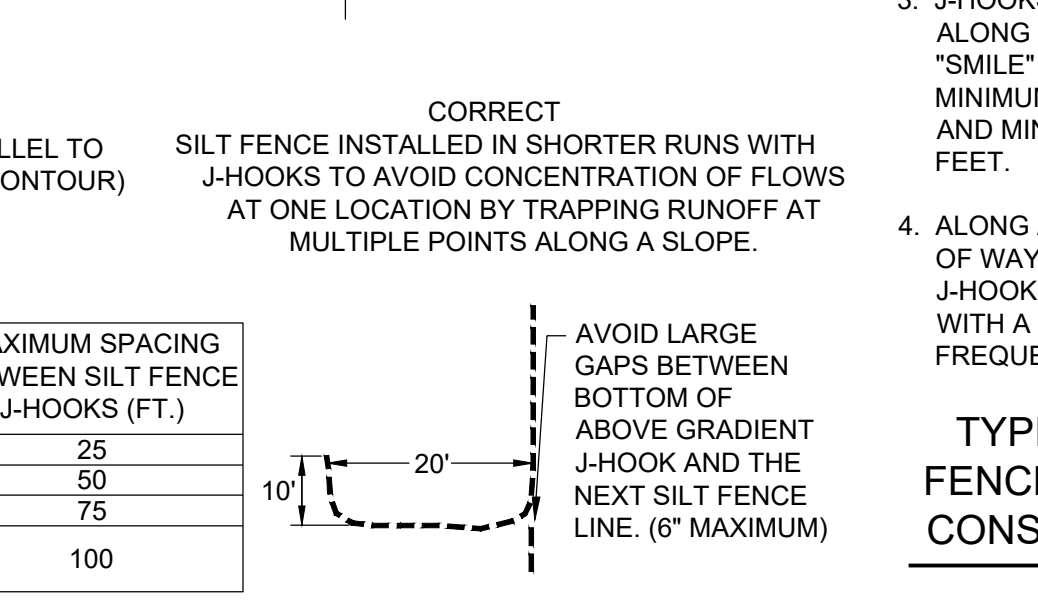

**TYPICAL WATTLE SECTION A-A**  
N.T.S.

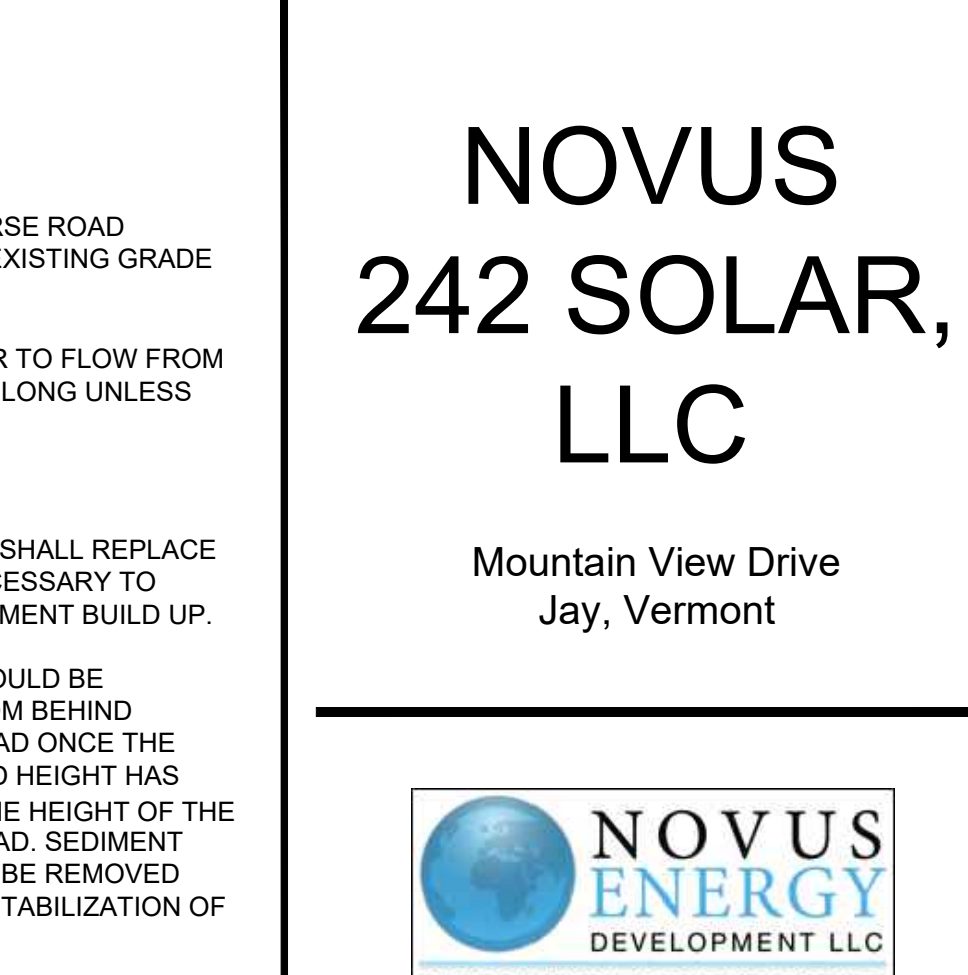

- NOTES**
- CONTRACTOR SHALL REPLACE STONE AS NECESSARY TO PREVENT SEDIMENT BUILD UP.
  - SEDIMENT SHOULD BE REMOVED FROM BEHIND DISPERSION PAD ONCE THE ACCUMULATED HEIGHT HAS REACHED 1/2 THE HEIGHT OF THE DISPERSION PAD. SEDIMENT SHOULD ALSO BE REMOVED AFTER FINAL STABILIZATION OF SITE.

**DISPERSION PAD DETAIL**  
N.T.S.

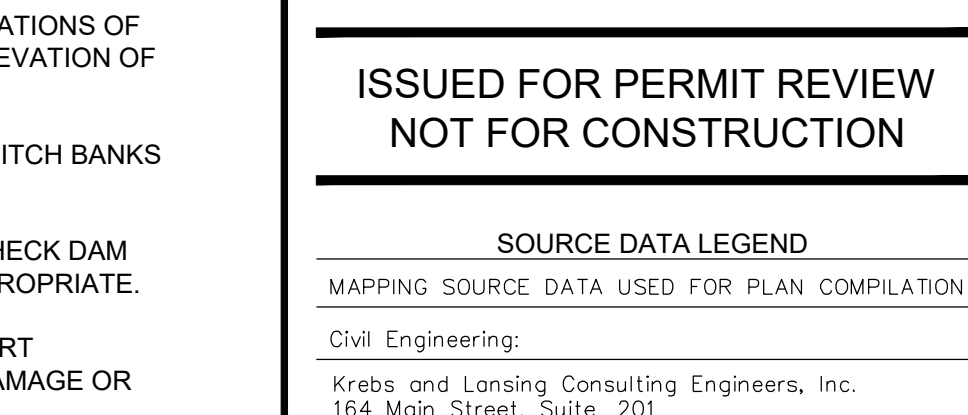

**TYPICAL WATTLE SECTION A-A**  
N.T.S.

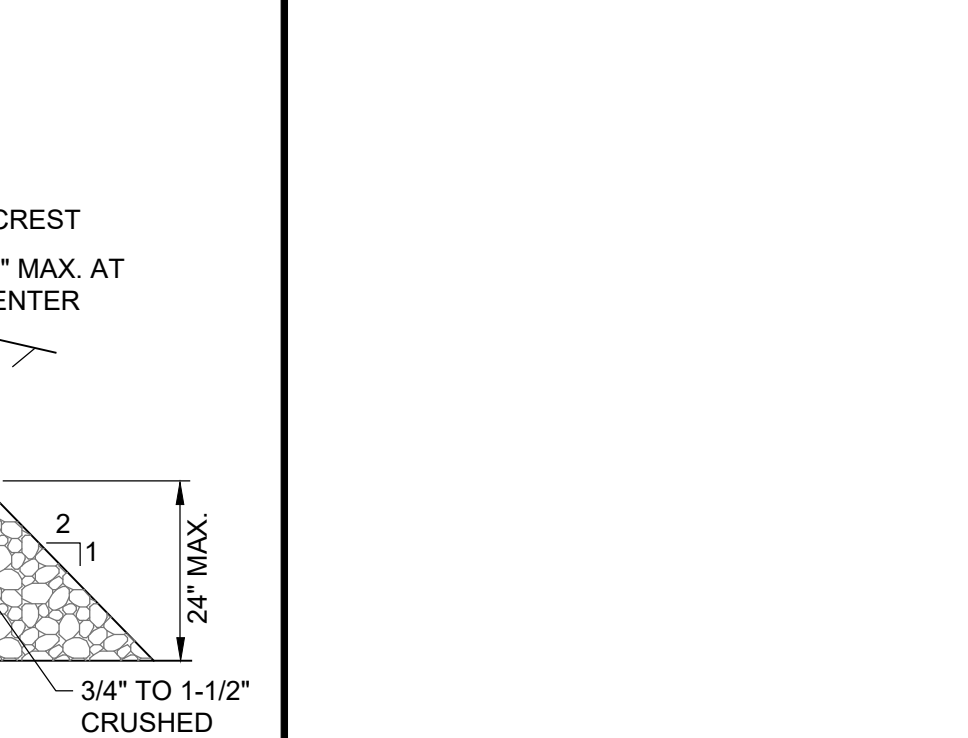

**TYPICAL WATTLE SECTION A-A**  
N.T.S.

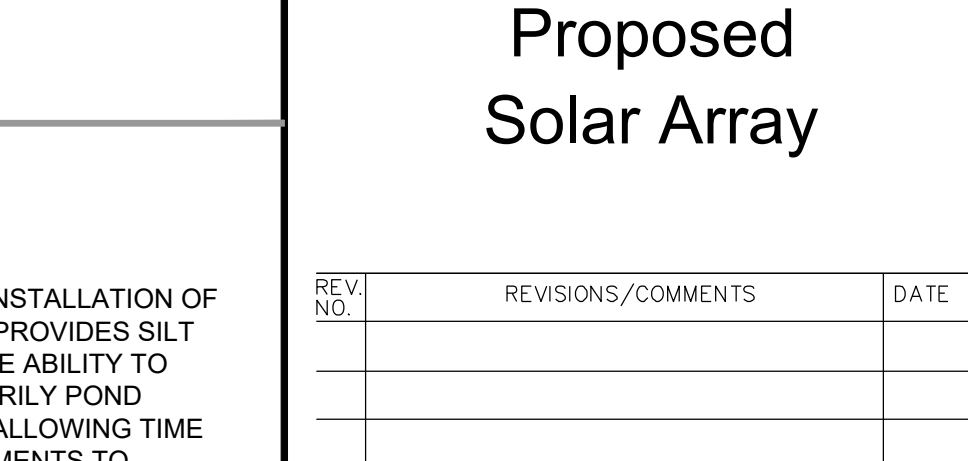

**TYPICAL WATTLE SECTION A-A**  
N.T.S.

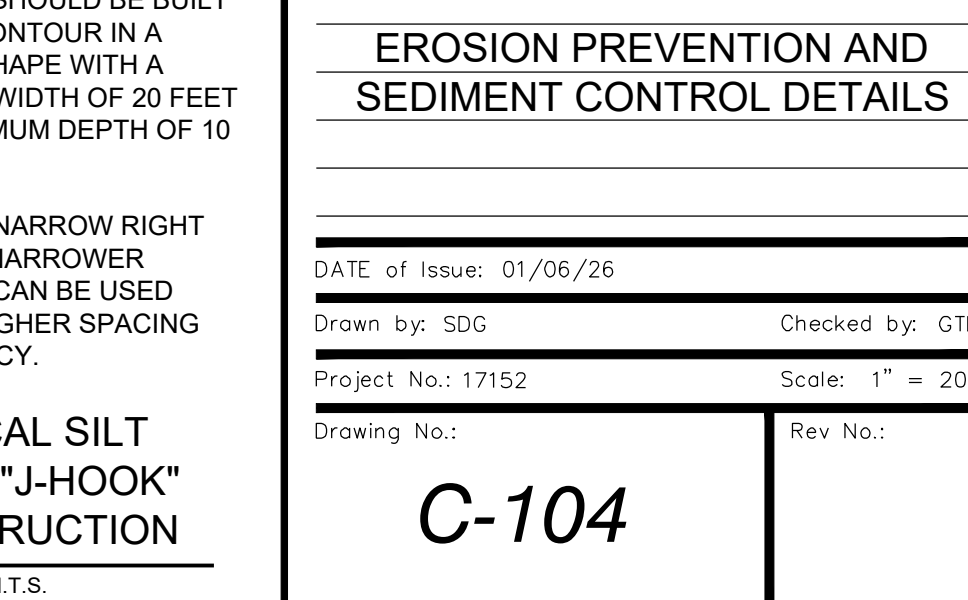

**TYPICAL WATTLE SECTION A-A**  
N.T.S.

**NOVUS 242 SOLAR, LLC**

Mountain View Drive  
Jay, Vermont



**ISSUED FOR PERMIT REVIEW NOT FOR CONSTRUCTION**

**SOURCE DATA LEGEND**

MAPPING SOURCE DATA USED FOR PLAN COMPIATION  
Civil Engineering:  
Krebs and Lansing Consulting Engineers, Inc.  
164 Main Street, Suite 201  
Colchester, Vermont 05446

**Proposed Solar Array**

REV. NO.	REVISIONS/COMMENTS	DATE

Drawing Title:

**EROSION PREVENTION AND SEDIMENT CONTROL DETAILS**

DATE of Issue: 01/06/26  
Drawn by: SDG Checked by: GJD  
Project No.: 17152 Scale: 1" = 20'  
Drawing No.: Rev No.:



