

Putney Green Acres Solar, LLC

River Road South
Putney, Vermont

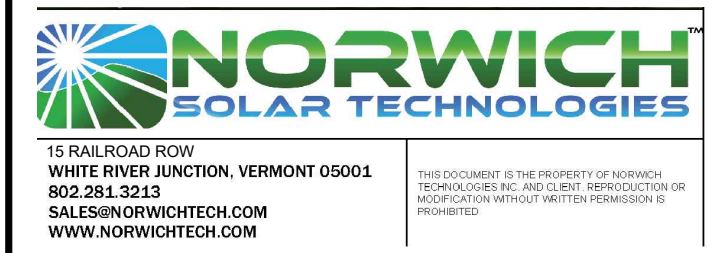

**ISSUED FOR PERMIT REVIEW
NOT FOR CONSTRUCTION**

SOURCE DATA LEGEND

MAPPING SOURCE DATA USED FOR PLAN COMPILATION

Electrical Design:
Norwich Solar Technologies
15 Railroad Row
White River Junction, Vermont 05001

Civil Engineering:
Krebs & Lansing Consulting Engineers, Inc.
164 Main Street, Suite 201
Colchester, Vermont 05446

Environmental:
Arrowood Environmental
950 Bert White Rd.
Huntington, Vermont 05462

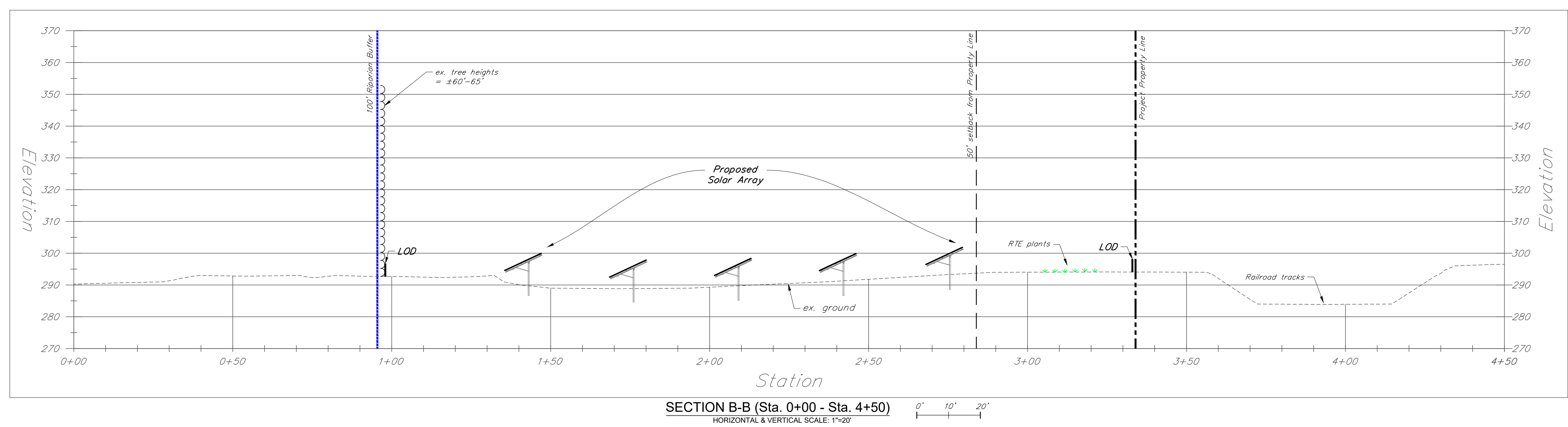
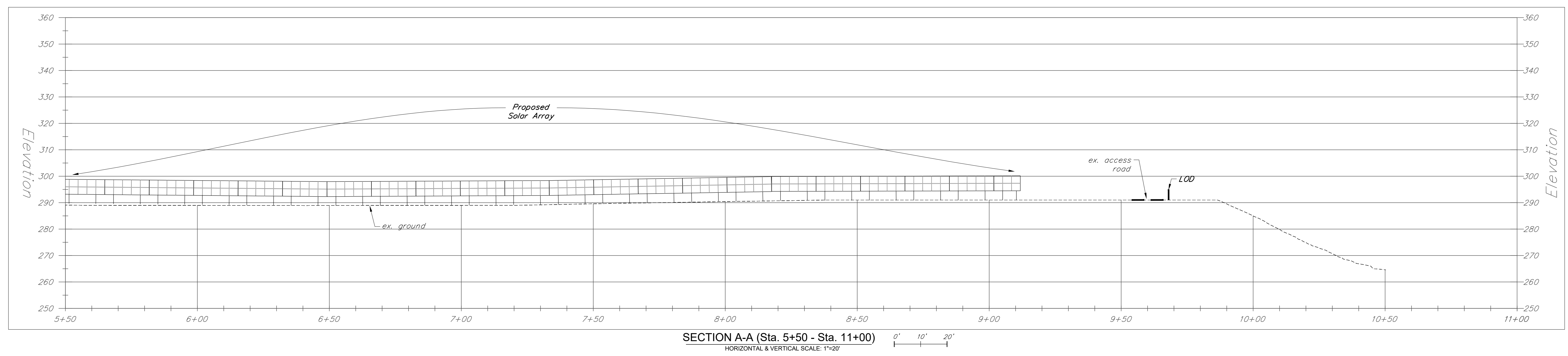
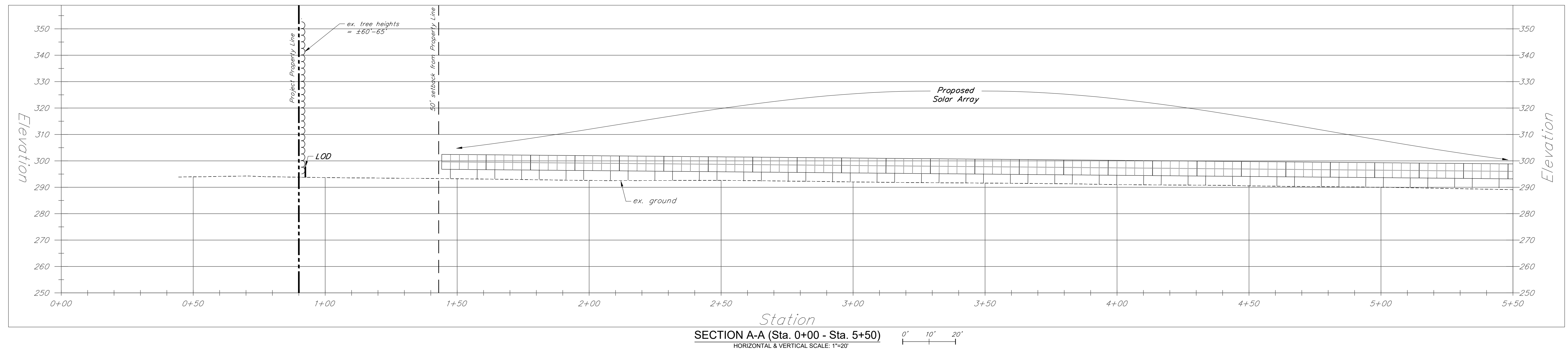
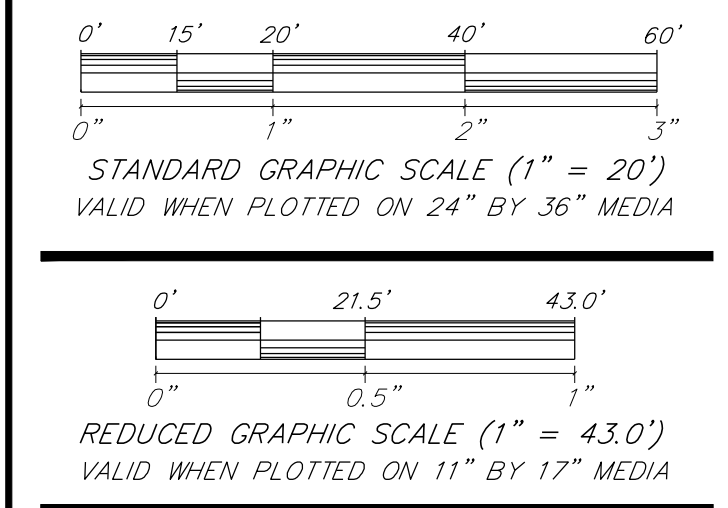

Proposed Solar Array

SET REV.	REVISIONS/COMMENTS	DATE

Drawing Title:

ELEVATION VIEWS

DATE of Issue: 01/18/2021
Drawn by: JBC Checked by: JBC
Project No.: 21102 Scale: 1" = 20'
Drawing No.: Rev No.:

C-101